

Construction Update: Bearspaw South Feeder Main Repair

October 29, 2024

The City of Calgary is making progress on the third phase of repairs to the Bearspaw South Feeder Main.

These repairs are taking place in three locations: repair site one is located on Parkdale Blvd N.W. between 26 St N.W. and 27 St N.W., repair site two is located on the Memorial Dr westbound off-ramp that connects to Crowchild Trail northbound, and repair site three is located at Brownsea Dr N.W. at the bottom of the Bev Longstaff Pedestrian Bridge ramp. These repairs are much smaller in scope and will not require city-wide water restrictions because these sections can be isolated while keeping the feeder main running.

NEW - Construction Update

Crews continue to progress as planned at all three repair sites.

As part of the repair work on Site 2, crews will temporarily remove two additional sections of the sound barrier just north of the current site on Thursday, Oct 31 and will proceed to make a small excavation to expose the pipe to proceed with the planned repair. This will result in some additional traffic noise to nearby homes. This sound barrier will be reinstalled once repairs are complete. (See map below.)

Updated: Project Map Site 2

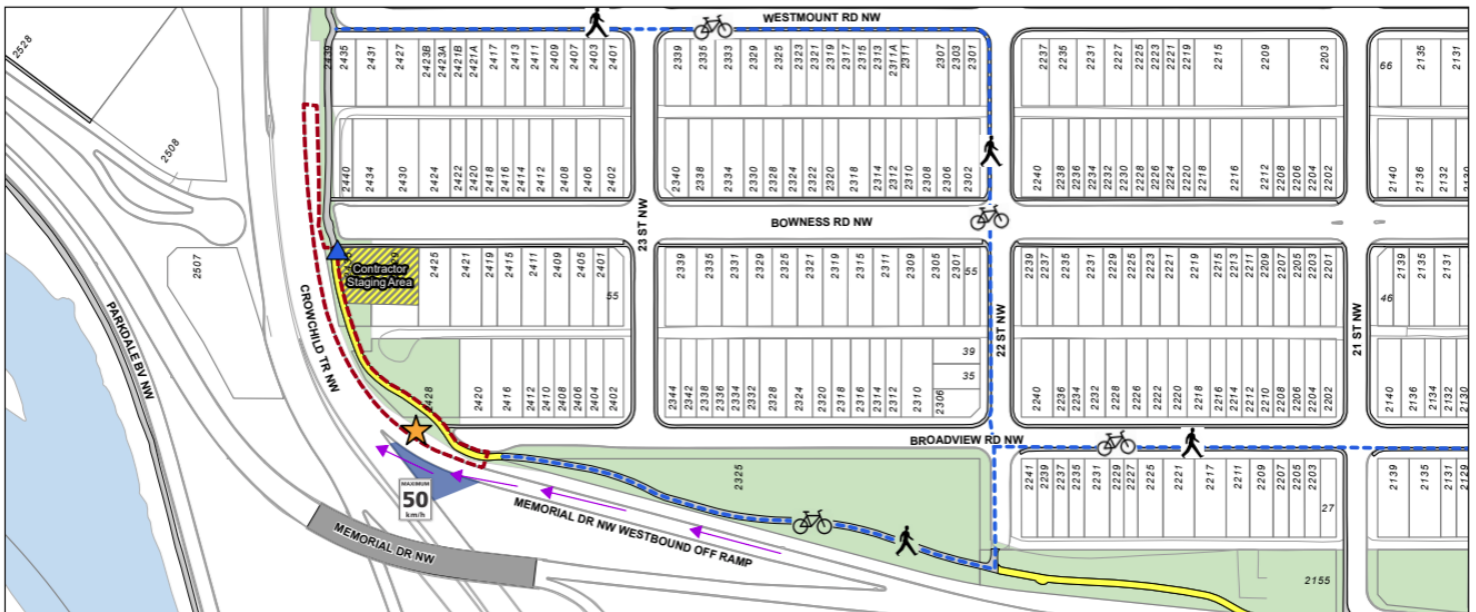

- Feedermain Repair Site
- Sound Barrier Removal and Excavation
- Traffic Flow
- Temporary Median
- Work Zone
- Contractor Staging Area

- Sidewalk/Pathway
- Pathway Closure
- Pathway Detour
- Bridge deck
- Parcel
- Hydrology
- Park

Date Printed: October 28, 2024



Construction Update: Bearspaw South Feeder Main Repair

October 29, 2024

REMINDER - Construction Impacts

- Traffic congestion on northbound Crowchild Trail N.W., westbound Memorial Drive N.W., Memorial Drive N.W. northbound off-ramp to northbound Crowchild Trail N.W, and both eastbound and westbound Parkdale Blvd N.W.
- Noise, dust and moderate vibration from equipment
- Use of bright construction spotlights
- Construction vehicles operating on residential roads, including Broadview Rd. N.W., 23 St N.W.
- Contractor staging area, including equipment storage and site offices located in green space at east end of Bowness Road, east of 23 St N.W. This green space will be fenced off and closed for the duration of construction.
- Work hours are anticipated to be 6:30 a.m. – 10 p.m. seven days a week.
- Periodic work into the night as required.
- Pathway closures and detours
- All business and residential access will remain open, but expect increased traffic congestion while work is taking place.

Project Information or Questions

We will provide regular updates on construction planning, road closures and detours.

Sign up for regular updates by scanning the QR code below.

Project updates can be found at [Calgary.ca/feedermain](https://calgary.ca/feedermain)

